

RFID Coded Non Contact Type: LPF

FEATURES:

Popular European fitting suitable for all industry applications
LED indication
Can be high pressure hosed at high temperature due to IP69K rating
Wide sensing at 14mm with high tolerance to misalignment
High specification polyester housing with integral back plate
Quick Connect versions available
Up to: PLe ISO13849-1
2NC 1NO circuits - high switching life - no moving parts
Magnet holding option available for use with small guards

DIMENSIONS:

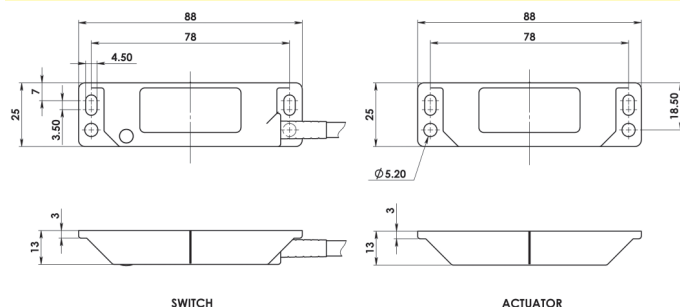

RFID Coded Actuation

Switching Tolerance up to 14mm

Will operate with most Safety Relays



OPERATING DIRECTION:

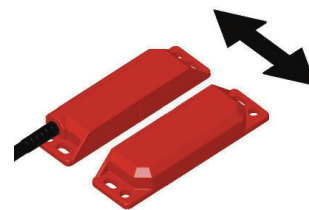

CONNECTION EXAMPLE

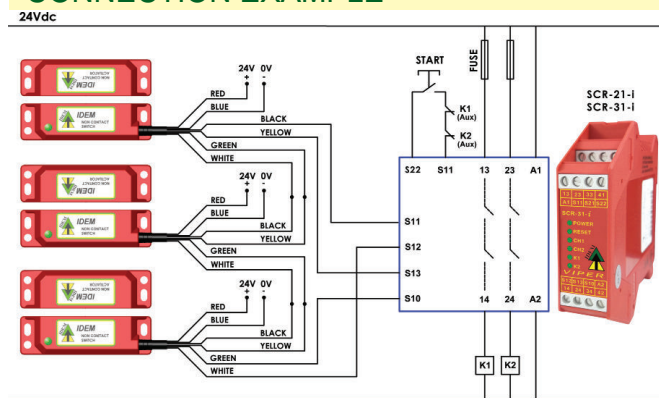

Three switches connected in series to an SCR-21-i or SCR-31-i to give Dual Channel monitoring with monitored Manual Start and Contactor Feedback Check

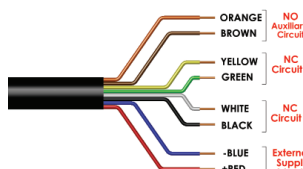
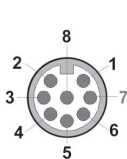

Quick Connect QC M12 8 Way Male Plug Pin view from Switch	Flying Lead Colour	Circuit (Actuator Present)	Output Types Solid State
8	Orange	Auxiliary NO	200mA Max. 24Vdc
5	Brown	Auxiliary NO	200mA Max. 24Vdc
4	Yellow	Safety NC2	200mA Max. 24Vdc
6	Green	Safety NC2	200mA Max. 24Vdc
7	Black	Safety NC1	200mA Max. 24Vdc
1	White	Safety NC1	200mA Max. 24Vdc
2	Red	Supply +24Vdc	Supply 24Vdc +/- 10%
3	Blue	Supply 0Vdc	Supply 24Vdc +/- 10%

SALES NUMBER	MASTER CODED (same code every switch)	CABLE LENGTH
404101	LPF-M-RFID	2M
404102	LPF-M-RFID	5M
404103	LPF-M-RFID	10M
404104	LPF-M-RFID	QC-M12
404201	Replacement Actuator Master Coded	

SALES NUMBER	UNIQUELY CODED (every switch unique activation)	CABLE LENGTH
404001	LPF-U-RFID	2M
404002	LPF-U-RFID	5M
404003	LPF-U-RFID	10M
404004	LPF-U-RFID	QC-M12

For all IDEM switches the normally closed (NC) circuits are closed when the guard is closed and the actuator is present.



140101	Female QC Lead	M12 Female 5m. 8 way
140102	Female QC Lead	M12 Female 10m. 8 way

Standards: ISO14119 EN60947-5-3 EN60204-1 ISO13849-1 EN62061 UL508

Safety Classification and Reliability Data:

Minimum switched current: 10V.dc 1mA
Dielectric Withstand: 250V.ac
Insulation Resistance: 100 Mohms
Recommended setting gap: 5mm
Switching Distance: Sao 10mm Close Sar 20mm Open
Tolerance to Misalignment: 5mm in any direction from 5mm setting gap
Switching frequency: 1.0 Hz maximum
Approach speed: 200mm/m to 1000mm/s
Body material: Polyester
Temperature Range: -25/80C
Enclosure Protection: IP67/IP69K
Cable Type: PVC 6 or 8 core 6mm OD Conductors 0.25mm²
Mounting Bolts: 2 x M4 Tightening torque 1.0 Nm
Mounting Position: Any

Characteristic Data according to IEC62061 (used as a sub system):

Safety Integrity Level SIL3
PFH (1/h) 4.77E-10 Corresponds to 4.8% of SIL3
PFD 4.18E-05 Corresponds to 4.2% of SIL3
Proof Test Interval T₁ 20a

Characteristic Data according to EN ISO13849-1:

Performance Level e If both channels are used in combination with a SIL3/PLc control device
Category Cat4
MTTFd 1100a
Diagnostic Coverage DC 99% (high)
Number of operating days per year: d_{op} = 365d
Number of operating hours per day: h_{op} = 24h
B10d not mechanical parts implemented

When the product is used deviant from these assumptions (different load, operating frequency, etc.) the values have to be adjusted accordingly.