

HYGIEMAG - Magnetic Non Contact Type: CMR

FEATURES:

Specifically designed for Food Processing applications -
 Stainless Steel 316 Mirror Polished finish (Ra4)
 Suitable for CIP and SIP cleaning -
 Food Splash Zones EHEDG guidelines
 Slim 20mm wide housing - can be fitted into narrow channels easily
 Wide sensing at 12mm with high tolerance to misalignment
 Can be high pressure hosed at high temperature
 High switching capability - up to 2.0A
 Up to: PLe ISO13849-1
 Quick Connect versions available

DIMENSIONS:

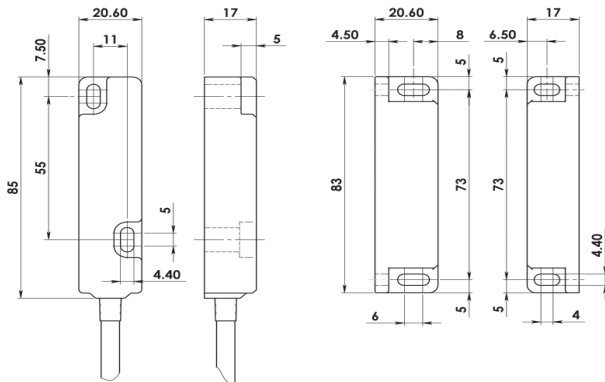

SWITCH

ACTUATOR

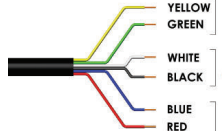
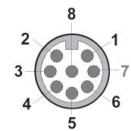

Quick Connect QC M12 8 Way Male Plug Pin view from Switch	Standard Lead Colour	Circuit (Actuator Present)
4	Yellow	NO
6	Green	NO
7	Black	NC2
1	White	NC2
2	Red	NC1
3	Blue	NC1

Standards: ISO14119 EN60947-5-1
 EN60204-1 ISO13849-1 EN62061 UL508

Safety Classification and Reliability Data:

Mechanical Reliability B10d	3.3 x 10 ⁶ operations at 100mA load
ISO13849-1	Up to PLe depending upon system architecture
EN62061	Up to SIL3 depending upon system architecture
Safety Data – Annual Usage PFHd	8 cycles per hour/24 hours per day/365 days
Proof Test Interval (Life) MTTFd	2.52 x 10 ⁻⁶
Heavy Duty	47 years
Safety Channel 1 NC	470 years
Safety Channel 2 NC	Voltage Free: 250Vac 2.0A Max. Rating
Safety Channel 3 NO	Voltage Free: 250Vac 2.0A Max. Rating
Fuse	Voltage Free: 24Vdc 0.2A Max. Rating
Medium Duty	Internal 2.0A (F) External 1.6A (F) (User)
Safety Channel 1 NC	Voltage Free: 250Vac 1.0A Max. Rating
Safety Channel 2 NC	Voltage Free: 250Vac 1.0A Max. Rating
Safety Channel 3 NO	Voltage Free: 24Vdc 0.2A Max. Rating
Fuse	Internal 1.0A (F) External 0.8A (F) (User)
Contact Release Time	<2ms
Initial Contact Resistance	<500 milliohm
Minimum Switched Current	10Vdc 1mA
Dielectric Withstand	250Vac
Insulation Resistance	100 Mohms
Recommended Setting Gap	5mm
Switching Distance (Target to Target)	Sao 10mm Close
Tolerance to Misalignment	Sar 22mm Open
Switching Frequency	5mm in any direction from 5mm setting gap
Approach Speed	1.0Hz maximum
Body Material	200mm/min to 1000mm/sec
Operating Temperature	Stainless Steel 316 mirror polished finish to Ra4
Enclosure Protection	-25C +105C (CIP SIP cleaning)
Shock Resistance	IP69K (NEMA PW12) IP67 (NEMA 6)
Vibration Resistance	IEC68-2-27 11ms 30g
Cable Type	IEC68-2-6 10-55Hz 1mm
Mounting Bolts	PVC 6 core 6mm OD Conductors 0.25mm ²
Mounting Position	2xM4 Tightening torque 1.0Nm
	Any

For all IDEM switches the normally closed (NC) circuits are closed when the guard is closed and the actuator is present.



Stainless Steel 316 Housing mirror polished (Ra4)
Magnetic Actuation - Power Series 230Vac/24Vdc 2.0A
Switching Tolerance up to 12mm
Will operate with most Safety Relays



Quick Connect M12 versions fitted with 250mm (10") cable

CONNECTION EXAMPLE: Magnetic Switches

Three switches connected in series to an SCR-21-i or SCR-31-i to give Dual Channel guard monitoring with Monitored Manual Start and Contactor Feedback check.

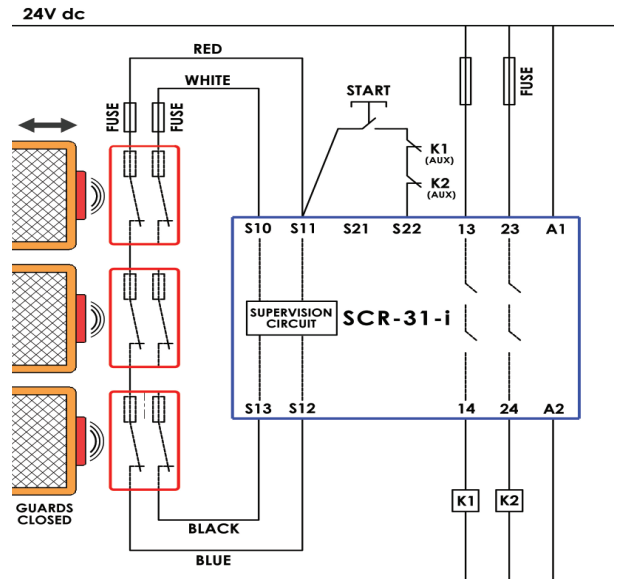

SALES NUMBER	TYPE	CABLE LENGTH	CIRCUITS	NC DUTY
138017	Hygiemag CMR	2M	2NC	Medium 1A
138018	Hygiemag CMR	5M	2NC	Medium 1A
138019	Hygiemag CMR	10M	2NC	Medium 1A
138020	Hygiemag CMR	QC-M12	2NC	Medium 1A
138021	Hygiemag CMR	2M	2NC 1NO	Medium 1A
138022	Hygiemag CMR	5M	2NC 1NO	Medium 1A
138023	Hygiemag CMR	10M	2NC 1NO	Medium 1A
138024	Hygiemag CMR	QC-M12	2NC 1NO	Medium 1A
138025	Hygiemag CMR	2M	1NC	Heavy 2A
138026	Hygiemag CMR	5M	1NC	Heavy 2A
138027	Hygiemag CMR	10M	1NC	Heavy 2A
138028	Hygiemag CMR	QC-M12	1NC	Heavy 2A
138029	Hygiemag CMR	2M	1NC 1NO	Heavy 2A
138030	Hygiemag CMR	5M	1NC 1NO	Heavy 2A
138031	Hygiemag CMR	10M	1NC 1NO	Heavy 2A
138032	Hygiemag CMR	QC-M12	1NC 1NO	Heavy 2A

140101	Female QC Lead	M12 Female 5m. 8 way
140102	Female QC Lead	M12 Female 10m. 8 way